

REPLAT IN
VOL: 9518
PAGE: 60

36155

GROVELAND

Subdivision of 5.119 acres in the City of San Antonio, Bexar County, Texas, known and described as Lot No Two (27), according to the subdivision and survey made by W. M. Locke Surveyor, on Jan. 13, 1894 for Lena Lick & Antonia Oram, out of that portion of Original City Lots Nos. 26 & 27 Range 1 District 2 lying East of River Avenue
Dated Sept. 5, 1912.

H. J. Hayes

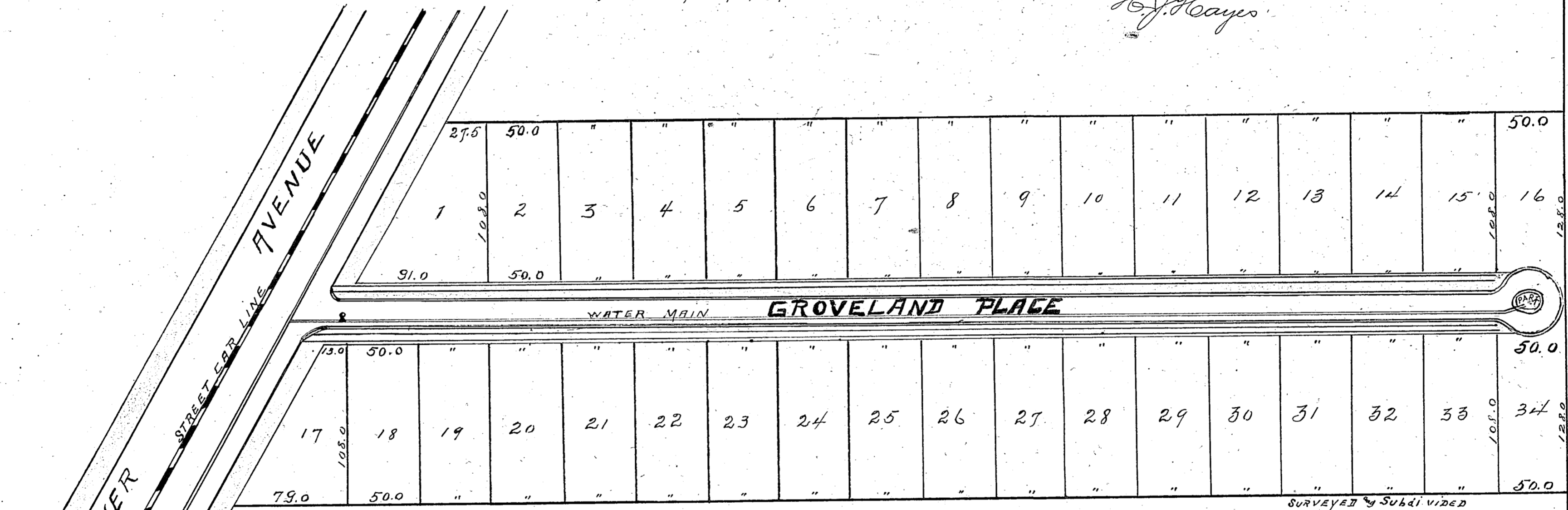

Scale 60' = 1"

SURVEYED & SUBDIVIDED
By H. J. RULLMAN, ENGR.

State of Texas } Before me the undersigned authority, on this day personally
County of Bexar } appeared H. J. Hayes, known to me to be the person whose
name is subscribed to the above and foregoing dedication and acknowledged
to me that he executed the same for the purposes therein above expressed.
Shown under my hand and seal of office this Sept. 5, 1912.

Seal

O. D. Mueller,
Notary Public, Bexar County, Texas.

State of Texas } This is to certify that the above plat is true
County of Bexar } and correct.
Henry Rullman
Sworn to before me this 30th day of August 1912.

Seal

F. M. Edwards,
Notary Public, Bexar County, Texas.

Filed for Record Sept 5 1912 @ 5²² O'clock P.M.
Recorded & Indexed Sept 6 1912 @ 11⁴⁰ O'clock P.M.

Frank R. Newton, County Clerk.
By Alex Long, Deputy.